



FALLBROOK PUBLIC UTILITY DISTRICT
BOARD OF DIRECTORS
SPECIAL BOARD MEETING AND FACILITIES TOUR

NOTICE AND AGENDA

PURSUANT TO WAIVERS TO CERTAIN BROWN ACT PROVISIONS UNDER EXECUTIVE ORDERS ISSUED BY GOVERNOR NEWSOM RELATED TO THE COVID-19 STATE OF EMERGENCY THIS MEETING WILL BE CONDUCTED VIA TELECONFERENCE USING THE BELOW INFORMATION.

MEMBERS OF THE PUBLIC ARE ENCOURAGED TO PARTICIPATE IN THE BOARD MEETING VIA TELECONFERENCE USING THE BELOW CALL-IN INFORMATION.

MEMBERS OF THE PUBLIC MAY SUBMIT COMMENTS ON AGENDA ITEMS IN ADVANCE IN ONE OF THE FOLLOWING WAYS:

- **BY EMAILING TO OUR BOARD SECRETARY AT LECKERT@FPUD.COM**
- **BY MAILING TO THE DISTRICT OFFICES AT 990 E. MISSION RD., FALLBROOK, CA 92028**
- **BY DEPOSITING THEM IN THE DISTRICT'S PAYMENT DROP BOX LOCATED AT 990 E. MISSION RD., FALLBROOK, CA 92028**

ALL COMMENTS SUBMITTED BY WHAT EVER MEANS MUST BE RECEIVED AT LEAST ONE HOUR IN ADVANCE OF THE MEETING. ALL COMMENTS WILL BE READ TO THE BOARD DURING THE APPROPRIATE PORTION OF THE MEETING. PLEASE KEEP ANY WRITTEN COMMENTS TO 3 MINUTES. THESE PUBLIC COMMENT PROCEDURES SUPERSEDE THE DISTRICT'S STANDARD PUBLIC COMMENT POLICIES AND PROCEDURES TO THE CONTRARY.

**AUDIO CALL-IN 1-408-418-9388
ACCESS CODE 126 284 9294
AUDIO PASSWORD 76777856**

**TUESDAY, NOVEMBER 10, 2020
2:00 P.M.**

**FALLBROOK PUBLIC UTILITY DISTRICT
990 E. MISSION RD, FALLBROOK, CA 92028
PHONE: (760) 728-1125**

If any accommodations are needed, please contact the Board Secretary at (760) 999-2704. Requests should be made as soon as possible prior to the scheduled meeting.

I. PRELIMINARY FUNCTIONS

CALL TO ORDER / ROLL CALL / ESTABLISH A QUORUM

PLEDGE OF ALLEGIANCE

PUBLIC COMMENT

Members of the public are invited to address the Board of Directors on agenda items. The Board President may limit comments to three (3) minutes.

II. FACILITIES TOUR

A. TOUR OF THE SANTA MARGARITA RIVER CONJUNCTIVE USE FACILITY

The meeting begins at 2:00 p.m., and the Board of Directors, staff, and others will assemble in their vehicles in the parking lot of the Fallbrook Public Utility District located at 990 East Mission Road, Fallbrook, California and will call in using the teleconference information identified above. Participants will each take their own vehicle to tour the Santa Margarita River Conjunctive Use Facility. All participants shall wear masks and comply with social distancing requirements in compliance with all State and County Health Officer Orders and/or guidelines, when outside of their individual vehicle. Members of the public are allowed to also attend in their individual vehicle and/or listen to the tour by using the call-in information noted above. No action will be taken by the Board of Directors at this meeting.

III. ADJOURNMENT OF MEETING

* * * * *

DECLARATION OF POSTING

I, Lauren Eckert, Executive Assistant/Board Secretary of the Fallbrook Public Utility District, do hereby declare that I posted a copy of the foregoing agenda in the glass case at the entrance of the District Office located at 990 East Mission Road, Fallbrook, California, at least 24 hours prior to the meeting in accordance with Government Code § 54956.

I, Lauren Eckert, further declare under penalty of perjury, under the laws of the State of California, that the foregoing is true and correct.

November 5, 2020
Dated / Fallbrook, CA

/s/ Lauren Eckert
Executive Assistant/Board Secretary

**FALLBROOK PUBLIC UTILITY DISTRICT
BOARD OF DIRECTORS
SPECIAL BOARD MEETING AND FACILITIES TOUR**

TOUR ITINERARY

**TUESDAY, NOVEMBER 10, 2020
2:00 P.M.**

**FALLBROOK PUBLIC UTILITY DISTRICT
990 E. MISSION RD, FALLBROOK, CA 92028
PHONE: (760) 728-1125**

1:45 P.M. – ARRIVE AT FPUD DISTRICT OFFICE PARKING LOT

2:00 P.M. – CALL MEETING TO ORDER

2:05 P.M. – DESCRIPTION OF TOUR

2:15 P.M. – DEPART FOR FPUD RECLAMATION PLANT AT 1425 ALTURAS ROAD

2:20 P.M. – ARRIVE AT PLANT

2:30 P.M. – EXIT VEHICLES FOR VERBAL PRESENTATION AT TAKE (SOCIALY DISTANCED) AND Q&A

2:50 P.M. – RESUME DRIVING TOUR ALONG PIPELINE ROUTE

3:05 P.M. – ARRIVE AT GHEEN RESERVOIR

3:05 P.M. – EXIT VEHICLES FOR SECOND VERBAL PRESENTATION AND Q&A

3:30 P.M. – TOUR COMPLETE

Participant Requirements:

- *All participants shall wear masks and comply with social distancing requirements in compliance with all State and County Health Officer Orders and/or guidelines, when outside of their individual vehicle.*

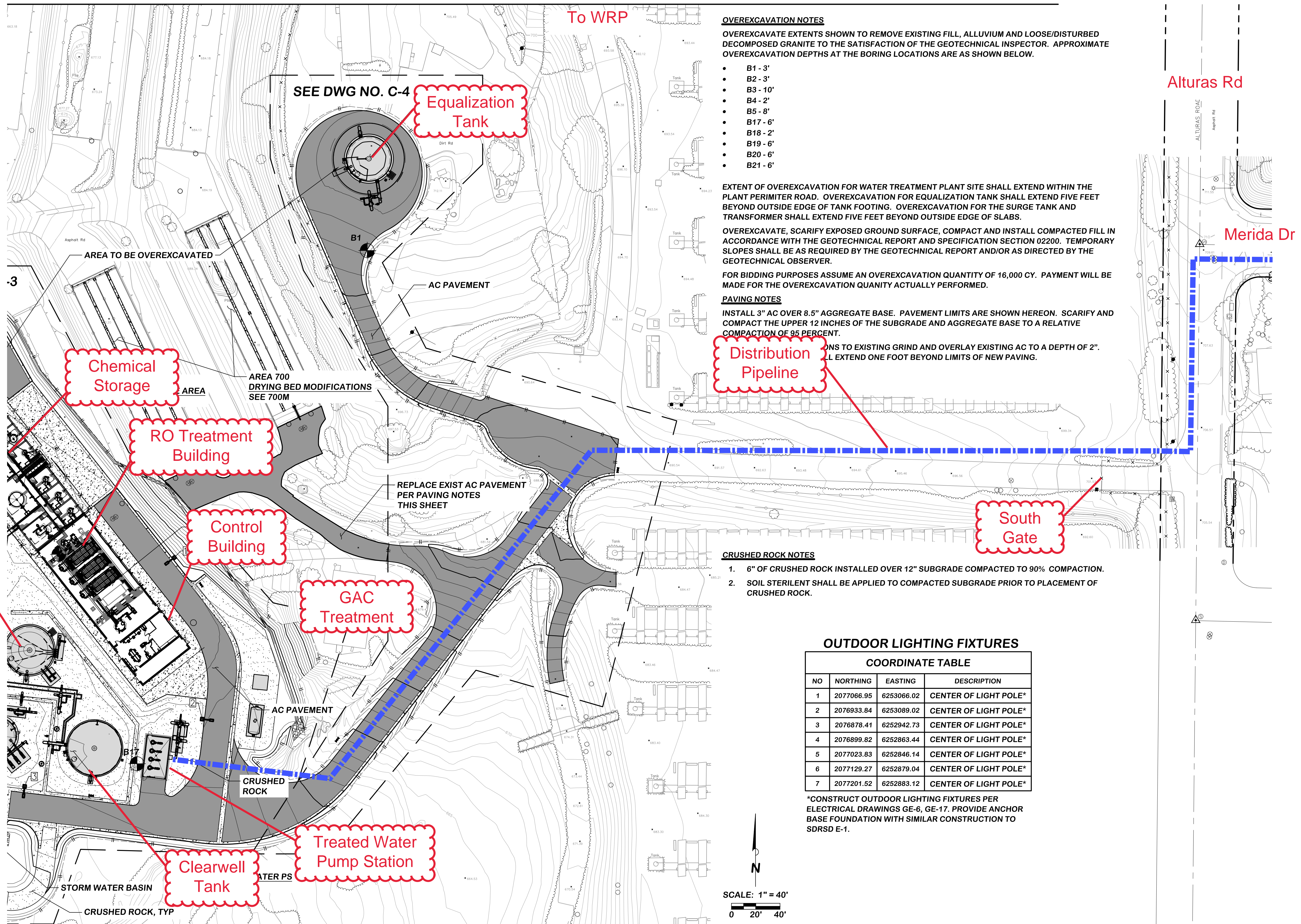

OVEREXCAVATION NOTES

OVEREXCAVATE EXTENTS SHOWN TO REMOVE EXISTING FILL, ALLUVIUM AND LOOSE/DISTURBED DECOMPOSED GRANITE TO THE SATISFACTION OF THE GEOTECHNICAL INSPECTOR. APPROXIMATE OVEREXCAVATION DEPTHS AT THE BORING LOCATIONS ARE AS SHOWN BELOW.

- B1 - 3'
- B2 - 3'
- B3 - 10'
- B4 - 2'
- B5 - 8'
- B17 - 6'
- B18 - 2'
- B19 - 6'
- B20 - 6'
- B21 - 6'

EXTENT OF OVEREXCAVATION FOR WATER TREATMENT PLANT SITE SHALL EXTEND WITHIN THE PLANT PERIMETER ROAD. OVEREXCAVATION FOR EQUALIZATION TANK SHALL EXTEND FIVE FEET BEYOND OUTSIDE EDGE OF TANK FOOTING. OVEREXCAVATION FOR THE SURGE TANK AND TRANSFORMER SHALL EXTEND FIVE FEET BEYOND OUTSIDE EDGE OF SLABS.

OVEREXCAVATE, SCARIFY EXPOSED GROUND SURFACE, COMPACT AND INSTALL COMPACTED FILL IN ACCORDANCE WITH THE GEOTECHNICAL REPORT AND SPECIFICATION SECTION 02200. TEMPORARY SLOPES SHALL BE AS REQUIRED BY THE GEOTECHNICAL REPORT AND/OR AS DIRECTED BY THE GEOTECHNICAL OBSERVER.

FOR BIDDING PURPOSES ASSUME AN OVEREXCAVATION QUANTITY OF 16,000 CY. PAYMENT WILL BE MADE FOR THE OVEREXCAVATION QUANTITY ACTUALLY PERFORMED.

PAVING NOTES

INSTALL 3" AC OVER 8.5" AGGREGATE BASE. PAVEMENT LIMITS ARE SHOWN HEREON. SCARIFY AND COMPACT THE UPPER 12 INCHES OF THE SUBGRADE AND AGGREGATE BASE TO A RELATIVE COMPACTION OF 95 PERCENT.

TRANSITIONS TO EXISTING GRIND AND OVERLAY EXISTING AC TO A DEPTH OF 2". ALL SHALL EXTEND ONE FOOT BEYOND LIMITS OF NEW PAVING.

CRUSHED ROCK NOTES

1. 6" OF CRUSHED ROCK INSTALLED OVER 12" SUBGRADE COMPACTED TO 90% COMPACTION.
2. SOIL STERILENT SHALL BE APPLIED TO COMPACTED SUBGRADE PRIOR TO PLACEMENT OF CRUSHED ROCK.

OUTDOOR LIGHTING FIXTURES

COORDINATE TABLE			
NO	NORTHING	EASTING	DESCRIPTION
1	2077066.95	6253066.02	CENTER OF LIGHT POLE*
2	2076933.84	6253089.02	CENTER OF LIGHT POLE*
3	2076878.41	6252942.73	CENTER OF LIGHT POLE*
4	2076899.82	6252863.44	CENTER OF LIGHT POLE*
5	2077023.83	6252846.14	CENTER OF LIGHT POLE*
6	2077129.27	6252879.04	CENTER OF LIGHT POLE*
7	2077201.52	6252883.12	CENTER OF LIGHT POLE*

*CONSTRUCT OUTDOOR LIGHTING FIXTURES PER ELECTRICAL DRAWINGS GE-6, GE-17. PROVIDE ANCHOR BASE FOUNDATION WITH SIMILAR CONSTRUCTION TO SDRSD E-1.

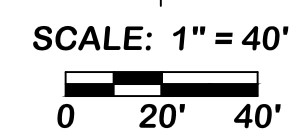

SCALE	1" = 40'
DATE	06/16/2017
PROJECT NO.	112.FPUD.0002
DESIGNED BY	RM
DRAWN BY	AS
CHECKED BY	RK

Infrastructure
ENGINEERING CORPORATION

14271 Danielson Street
Poway, California 92064
T 858.413.2400 F 858.413.2440
www.iecorporation.com

REGISTERED PROFESSIONAL ENGINEER
ROSS W. MAXWELL
No. C92681
Exp. 9-30-18
CIVIL
STATE OF CALIFORNIA

06/16/2017
DATE

FD
Fallbrook Public Utility District

990 E. MISSION RD
FALLBROOK, CA 92028

APPROVED BY:
JACK R. BEBEE, P.E.
ASSISTANT GENERAL MANAGER

DATE

**SANTA MARGARITA CONJUNCTIVE USE
PROJECT FACILITIES**

**WTP SITE PLAN
ABOVE GRADE IMPROVEMENTS**

DRAWING NO.	C-1
SHEET NO.	16 OF 387
CLIENT JOB NO.	2744